

TYPICAL ASPHALTIC ENTRANCE ROADWAY SECTION A-A
 NOT TO SCALE

LEGEND: FOR ASPHALT PAVING

- ① 4" THICK (MIN.) ASPHALT PAVEMENT. (2" TYPE DPW-1 WEARING COURSE, 2" TYPE 3 - BINDER COURSE)
- ② 6" (MIN.) AGGREGATE COMPACTED TO 95% OF ITS STANDARD PROCTOR DENSITY.
- ③ MIN. 6" THICK, SHOULDER BACKFILL MATERIAL, COMPACTED TO 92% OF ITS STANDARD PROCTOR DENSITY. MATERIAL TO BE IN COMPLIANCE WITH THE APPLICABLE SECTION OF THE LOUISIANA DEPARTMENT OF TRANSPORTATION STANDARD SPECIFICATIONS FOR ROADS AND BRIDGES, AND LATEST REVISIONS THERETO.
- ④ 1 1/2" THICK (AVG.) ASPHALT PAVEMENT. (TYPE DPW-1 WEARING COURSE) OVER EXISTING ROADWAY.
- ⑤ EXISTING GROUND.

BASE PREPARATION AND PAVING NOTES:

- 1. ALL WORK AND MATERIAL TO BE IN COMPLIANCE WITH LOUISIANA DEPARTMENT OF TRANSPORTATION STANDARD SPECIFICATIONS FOR ROADS AND BRIDGES, LATEST EDITION, UNLESS OTHERWISE NOTED.
- 2. EXISTING TOP SOIL IN PROPOSED ROAD BED TO BE EXCAVATED AND REMOVED AS NECESSARY FOR FINAL GRADE.
- 3. GRAND SHOULDERS AWAY FROM ASPHALT.

NOTES:

- 1. ALL CONSTRUCTION ACTIVITIES TO BE ACCOMPLISHED BETWEEN 6:00 A.M. AND 6:00 P.M.
- 2. CONSTRUCTION ON THE EXISTING ROAD IS TO BE STARTED AFTER NEW ENTRANCE ROAD IS FINISHED SO THAT TRAFFIC COMING IN AND OUT OF THE SUBDIVISION IS NOT INTERRUPTED.

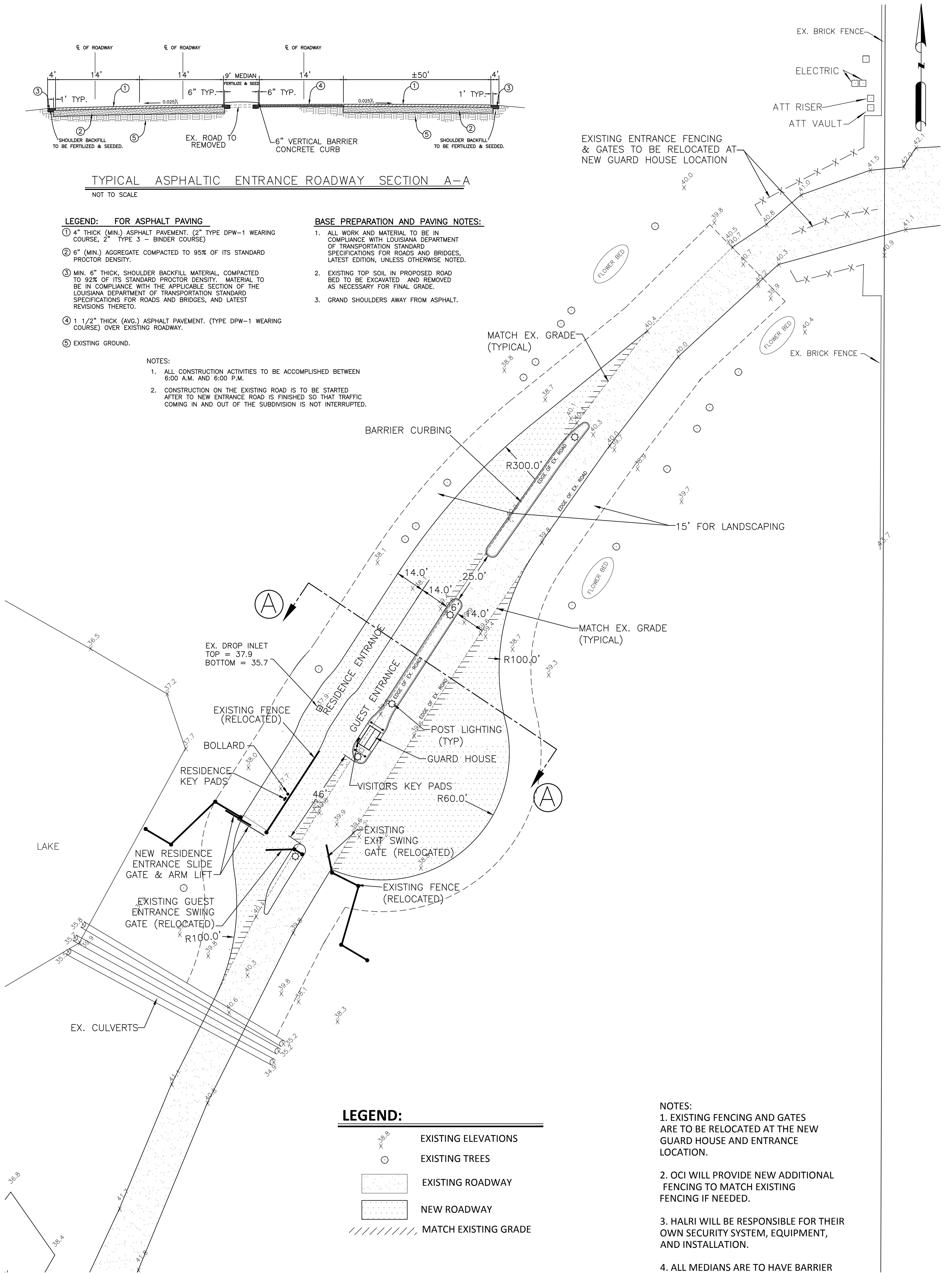

LEGEND:

- EXISTING ELEVATIONS
- EXISTING TREES
- EXISTING ROADWAY
- NEW ROADWAY
- MATCH EXISTING GRADE

NOTES:

- 1. EXISTING FENCING AND GATES ARE TO BE RELOCATED AT THE NEW GUARD HOUSE AND ENTRANCE LOCATION.
- 2. OCI WILL PROVIDE NEW ADDITIONAL FENCING TO MATCH EXISTING FENCING IF NEEDED.
- 3. HALRI WILL BE RESPONSIBLE FOR THEIR OWN SECURITY SYSTEM, EQUIPMENT, AND INSTALLATION.
- 4. ALL MEDIANS ARE TO HAVE BARRIER CURBS TO HELP PREVENT VEHICLES FROM DRIVING UP ONTO THE MEDIANS.
- 5. GUARD HOUSE TO BE BUILT ABOVE BASE FLOOD ELEVATION, WHICH WILL BE PROVIDED BY SURVEYOR.

ENTRANCE BOULEVARD PLAN

SCALE: 1" = 20'

S-1	REVISION NO:	12-10-2012
	DATE:	10-9-2012
	DRAWN BY:	RSB
	SCALE:	1" = 20'
	COMPUTER FILE:	MAMOULIDAS01047
	ENTRANCE BOULEVARD PLANS	
	SHEET	

CLIENT:	JOHN MAMOULIDES
PROJECT DESCRIPTION:	ENTRANCE BOULEVARD PLAN LAKE RAMSEY SUBDIVISION SECTION 10, 11 & 14, TOWNSHIP 6 SOUTH, RANGE 10 EAST ST. TAMMANY PARISH, LOUISIANA

Scalfano
ENGINEERING, INC.

28661 Krentel Road, Lacombe, Louisiana 70445-3367
 Ph.: (985) 882-6363-Fax (985) 882-6322
 Email: david@northlake-eng.net